

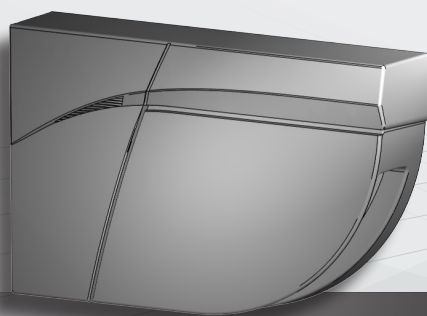

EN



Watch our FLATSCAN SW tutorial online: bea-flatscan.com/tutorial



LZR[®]-FLATSCAN SW

SAFETY SENSOR
FOR AUTOMATIC SWING DOORS



User's Guide for product version 0202 and higher
See product label for serial number

INSTALLATION TIPS

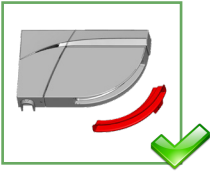

Remove the laser window protection before the teach-in and the commissioning of the sensor.

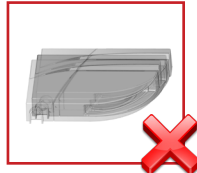

Avoid vibrations.

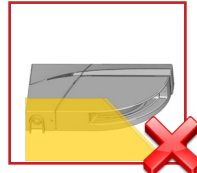

Do not cover the laser window.

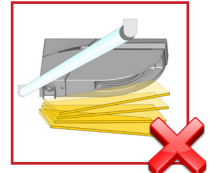

Avoid moving objects and light sources in the detection field.



Avoid the presence of smoke and fog in the detection field.

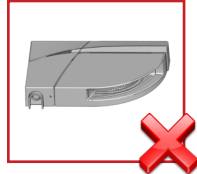

Avoid condensation.

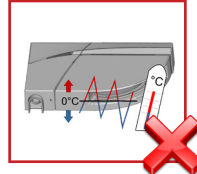

Avoid exposure to sudden and extreme temperature changes.

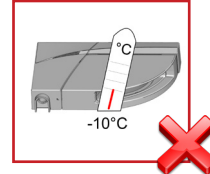

Keep the sensor permanently powered in environments where the temperature can descend below -10°C.

MAINTENANCE TIPS

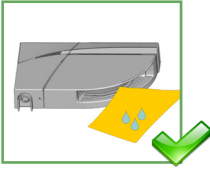

Clean the laser window with compressed air. If needed, wipe only with a soft, clean and damp microfiber cloth.



Do not use dry or dirty towels or aggressive products to clean the laser window.

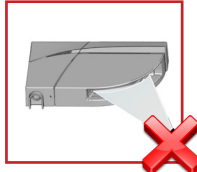

Avoid direct exposure to high pressure cleaning.

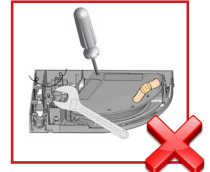

The warranty is invalid if unauthorized repairs are made or attempted by unauthorized personnel.

SAFETY TIPS

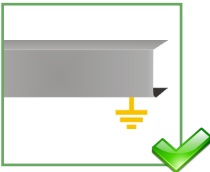

The door control unit and the door cover profile must be correctly earthed.

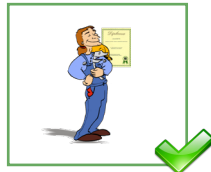

Only trained and qualified personnel may install and setup the sensor.



Always test the good functioning of the installation before leaving the premises.

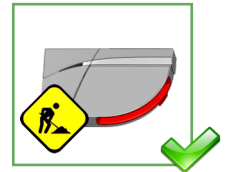

Do not remove the laser window protection when building works are still in progress on site.



- The device cannot be used for purposes other than its intended use. All other uses cannot be guaranteed by the manufacturer of the sensor.
- The manufacturer of the door system is responsible for carrying out a risk assessment and installing the sensor and the door system in compliance with applicable national and international regulations and standards on door safety.
- The manufacturer of the sensor cannot be held responsible for incorrect installations or inappropriate adjustments of the sensor.

DESCRIPTION





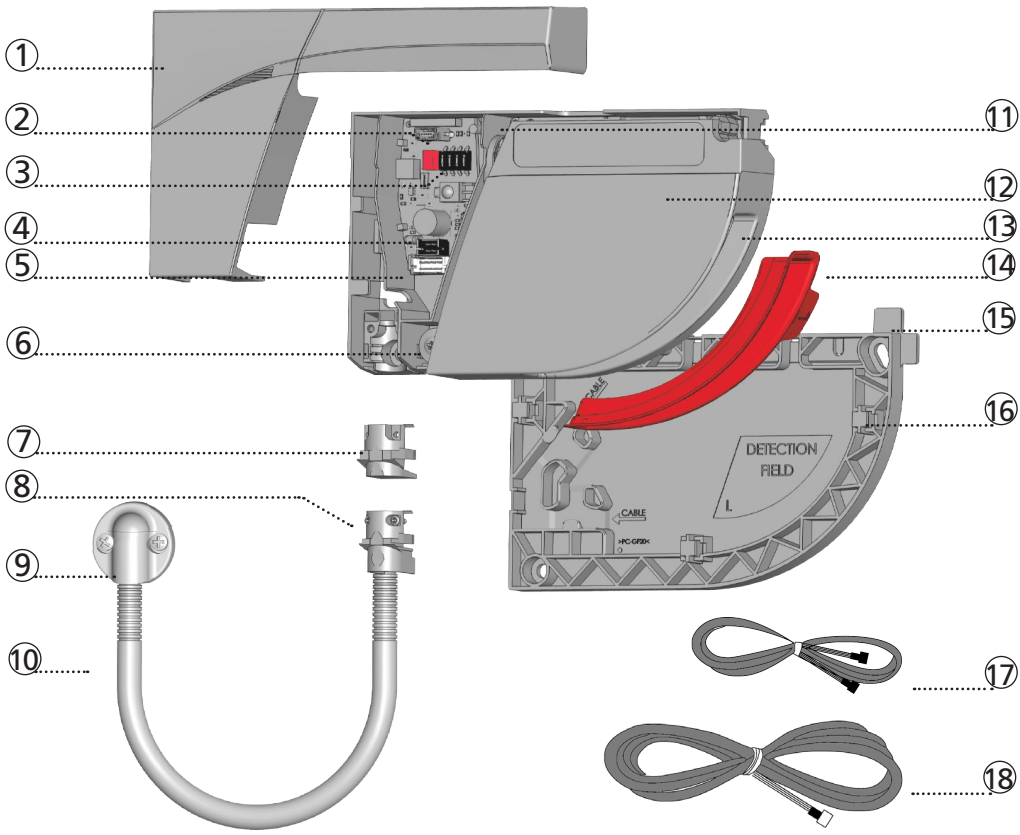





The LZR®-FLATSCAN SW is a safety sensor for automatic swing doors based on laser technology. It secures the moving door wing as well as the hinge area. To do so, a module must be installed in the upper corner of the door wing on both sides of the door.



- | | | |
|---------------------------|----------------------------------|-----------------------------|
| 1. cover | 7. plug | 13. laser window |
| 2. push button | 8. clamp | 14. laser window protection |
| 3. DIP-switch | 9. cap and screws (flexible kit) | 15. positioning aids |
| 4. master-slave connector | 10. flexible tube | 16. mounting base |
| 5. main connector | 11. lock screw | 17. master-slave cable |
| 6. angle adjustment screw | 12. laser head | 18. power cable |

LED-SIGNALS

 Relay 1	 Relay 2	 Calculation in progress Exit the zone and wait
 LED flashes	 LED flashes x times	 LED flashes red-green
	 LED flashes slowly	 LED flashes quickly
		 LED is off

1 MOUNTING ON DOOR



For optimum safety, install 1 module on each door wing side and interconnect them via the master-slave cable.

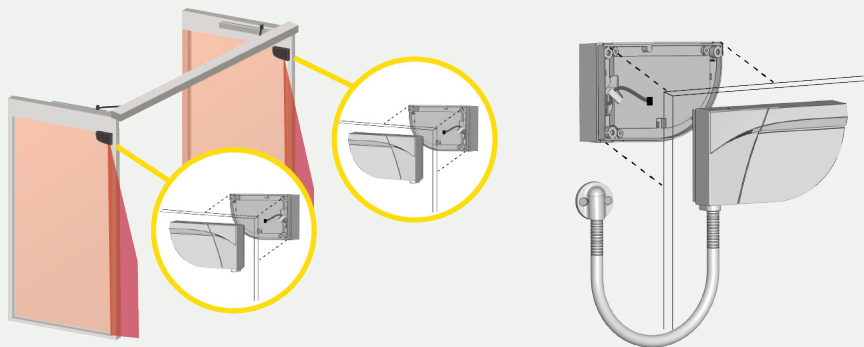

Keep a minimum distance of 15 cm between the FLATSCAN and radar sensors or use the LZR®-FLATSCAN Protective cover to avoid unwanted reactions of the door.

1

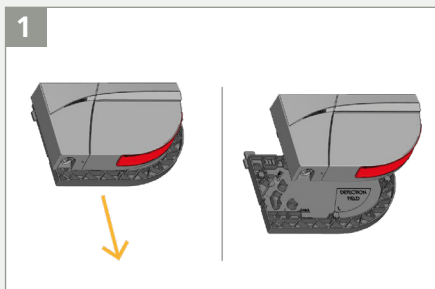

Slide the base off the sensor module.

2

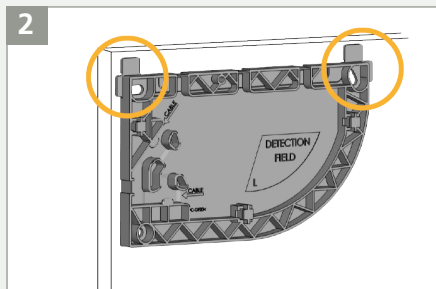

Take the base and put it on the door frame.
The positioning aids help you to align the base correctly.



When mounting the base, make sure the sensor will not hinder the door movement.
If the sensor isn't correctly positioned, it could be crushed during the opening of the door.

3

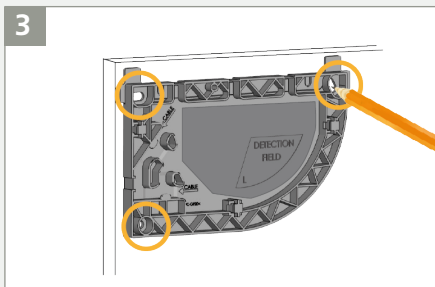

Using a pencil, mark the position of the holes to drill into the door frame. You can also use the inner surface of the base to fasten the screws.

4

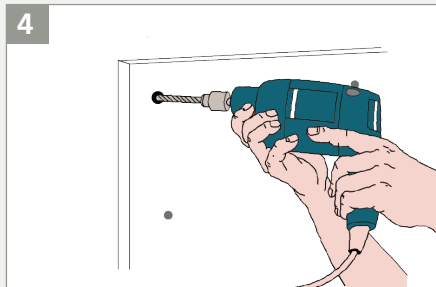

Remove the base and pre-drill the holes where marked.

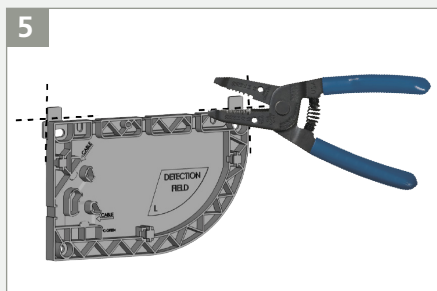

Using a wire cutter, remove the positioning aids from the base.

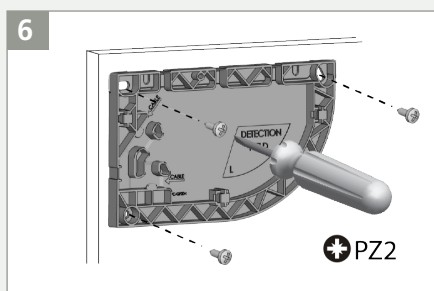

⚠ Fasten the 3 screws using a Pozidrive screwdriver. The base needs to be fixed firmly!



When installing the FLATSCAN on a fire door, use the LZR®-FLATSCAN Fire Door Accessory (FDA).

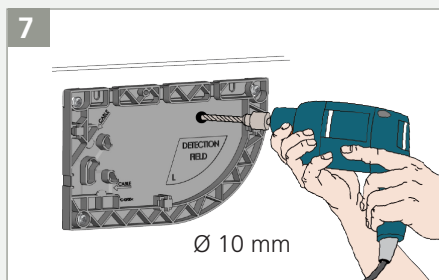

Drill through the 2 bases and the door using a 10 mm bit in order to pass the master-slave cable. Soften the edges using a sheet of sandpaper.

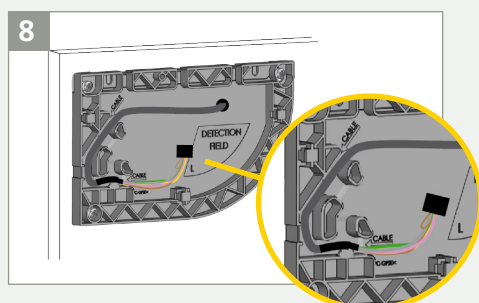

Take the master-slave cable and pass it through the hole. Position the cable in the notch of the base and make sure it is firmly fixed.

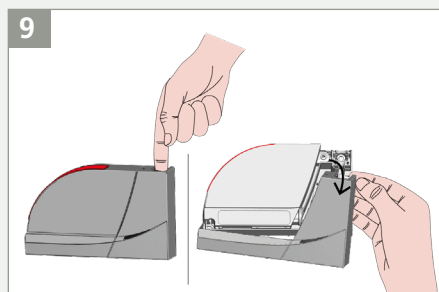

Take the sensor and remove the cover: put your finger in the hole and pull firmly towards you in one movement.

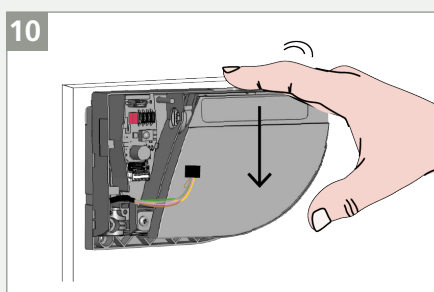

Pass the cable through the hole on the back of the sensor and fasten the sensor on the base by sliding it downwards.

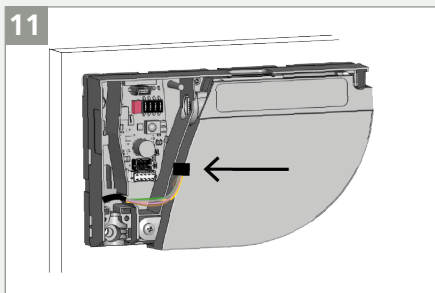

Connect the black plug to the black connector.

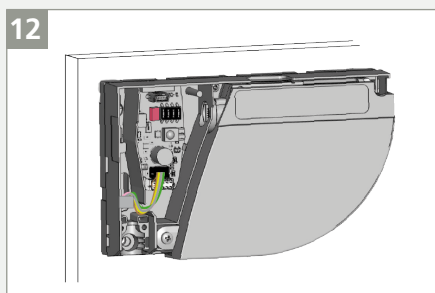

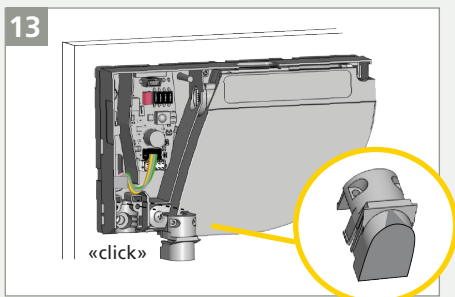

Make sure that all wires are safely tucked within the notch to avoid crushing them with the cover.

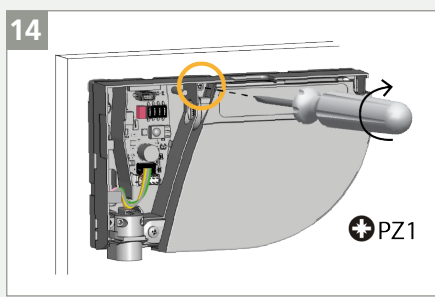

Close the sensor which will not be connected to the door controller using a plug.

 Sensor connected to other module = SLAVE



 Fasten the lock screw firmly.

2 WIRING TO DOOR CONTROLLER

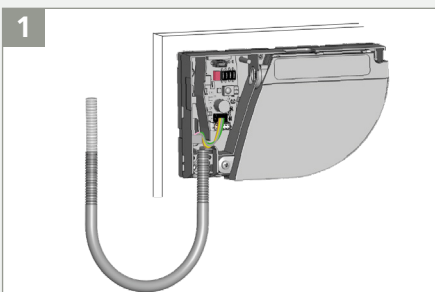

Take the flexible tube and determine how long it should be in order to reach the door controller.

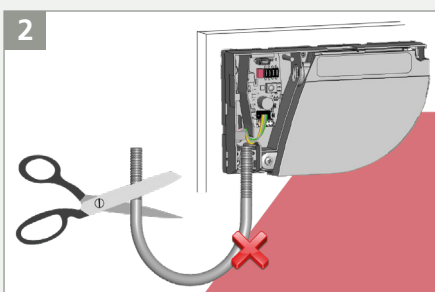

Cut the surplus to avoid undesired detections caused by the flexible tube.

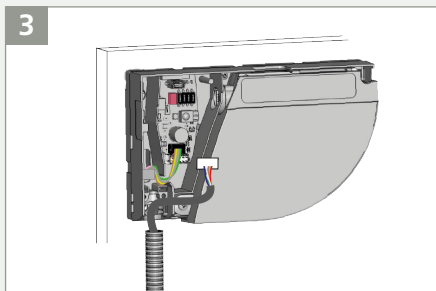

Pass the power cable through the flexible tube. Connect the white plug to the white connector.

 Sensor connected to door controller = MASTER

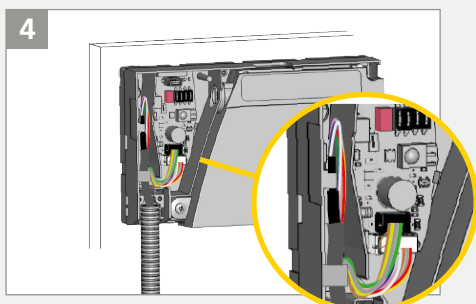

Make a loop with the wires of the power cable and pass them through the notch as indicated. Use the other part of the cable to block the wires.

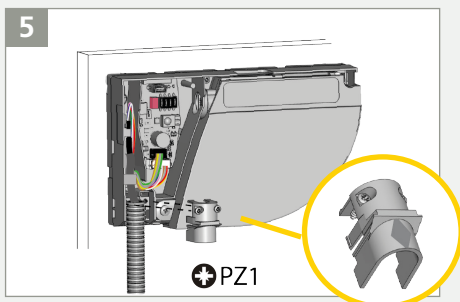

Take the clamp to fix the flexible tube to the sensor. Fasten the 2 screws firmly in order to avoid pulling out the cable.

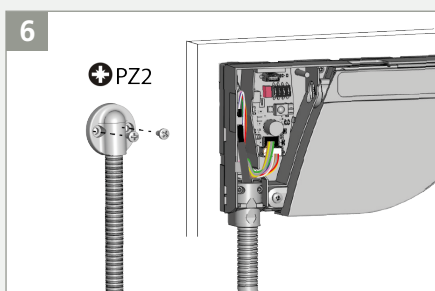

Tighten the other side of the flexible tube using the cable cap and pass through the rest of the power cable towards the door controller.

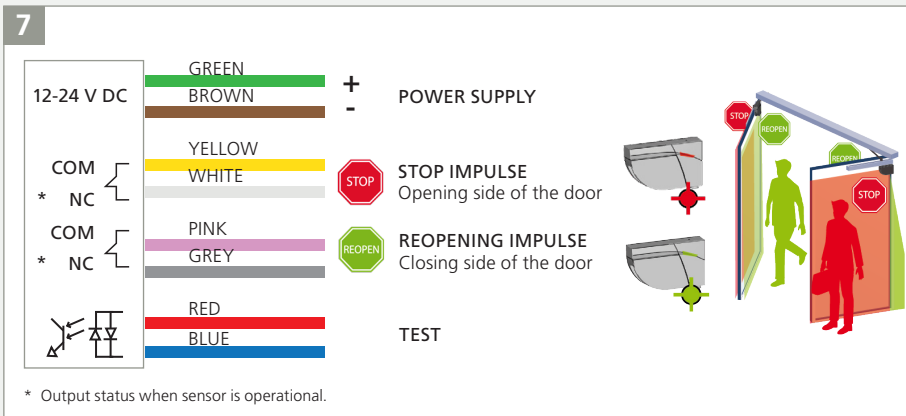

Cut the power cable to the right length, strip the 8 wires and connect all wires as indicated.

The polarity of the power supply is important.

For compliance with EN 16005 and DIN 18650, the door controller test output must be connected and able to test the sensor.



3 DIP-SWITCH 1

Make sure the setting of DIP 1 is correct on all modules according to the door

ON



RELAY 1: STOP-impuls on the opening side of the door

OFF



RELAY 2: REOPENING-impuls on the closing side of the door

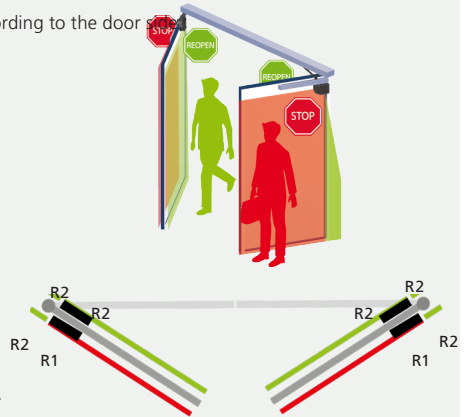

ORANGE



GREEN



OFF

After changing a DIP-switch, the orange LED flashes. A LONG push on the push button confirms the settings. Afterwards, a number of green flashes (x) indicates the number of connected modules.

> 3 sec.

4 TEACH-IN



Before launching a teach-in, make sure that:

- **glass surfaces near the door are covered**
- the door controller is set up first
- the door is closed (use the service mode if needed, see page 9)
- the door controller is connected to both relay outputs and is fully reacting to them
- the master-slave cable is connected between the modules
- the detection field is free of snow buildups, heavy rain, snowfall, fog or other objects or people
- the laser window protection is removed.

1. To launch a teach-in, press the push button of the master* module briefly. The LED starts to flash red-green quickly. When installing the sensor on a double swing door, repeat this on the second master module.
2. Wait until both sensors flash green. Position yourself in front of the door and stretch out your arm in front of you. Make an up and down movement at closing edge level in order to mark the limit of the detection zones. The LED flashes red while calculating the width of the door wings.
3. Wait until the sensors flash green again. Make sure you are outside of the detection field and activate a door opening so the sensors can learn the environment. During the closing of the door, the sensor flashes red.
4. Once the door is completely closed again and the LED is off, the teach-in is completed.

* A teach-in on the master configures both the master and the slave. A teach-in on the slave only configures the slave. In case the master and slave module are not aligned, first launch a teach-in on the master and then on the slave.

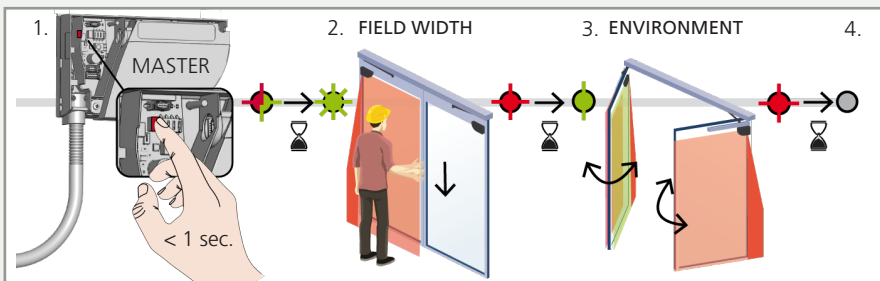

5 TESTING AND ADJUSTING



Check the correct positioning of the safety fields by placing an object in the detection field.

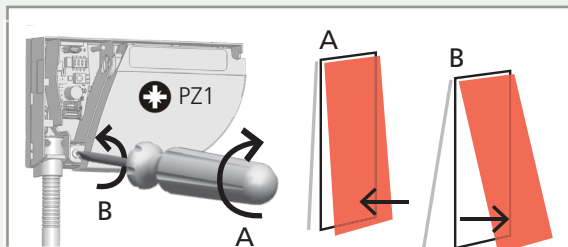

If necessary, adjust the tilt angle of the laser curtain by turning the tilt angle adjustment screw (from 2° to 10°).

! After changing the angle, the sensor position or the environment, always launch a teach-in and test the correct positioning of the detection fields.

6 FINAL STEPS

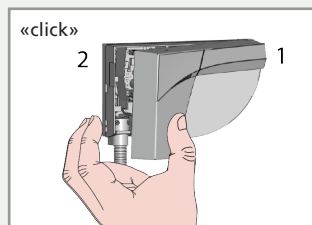

Close the cover starting on the narrow side (1). Do not hesitate to push.

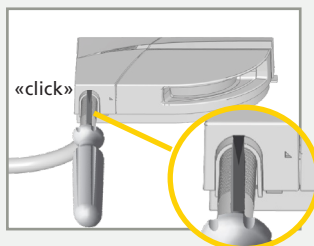

To open the sensor again, position a screwdriver in the notch and pull upwards until the cover comes loose.

Watch our FLATSCAN SW tutorial online: bea-flatscan.com/tutorial



SERVICE MODE

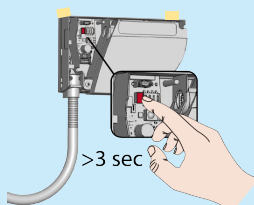

The service mode deactivates the safety detection during 15 minutes and can be useful during an installation, a mechanical teach-in of the door or maintenance work.

To enter the service mode, push on the button for at least 3 seconds. When the sensor is in service mode, the LED is off.
To exit the service mode, push again for at least 3 seconds.

The service mode is deactivated automatically when launching a teach-in.





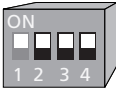

DIP-SWITCH SETTINGS (OPTIONAL)



	ON	OFF	
DIP 2 ENVIRONMENT	standard	critical*	Switch to CRITICAL when external disturbances are likely to cause unwanted detections (min. obj size, immunity and uncovered zone are increased).
DIP 3 BACKGROUND	on	off	Switch to OFF when there is no background (glass floor, footbridge...).
DIP 4 PINCH ZONE	on	off	Switch to OFF when the hinge area does not need to be secured and objects can cause unwanted detections.

* Make a risk analysis to check if the environment requires an additional mechanical protection in the hinge area.





ORANGE GREEN OFF

After changing a DIP-switch, the orange LED flashes. A LONG push on the push button confirms the settings. Afterwards, a number of green flashes (x) indicates the number of connected modules.

REMOTE CONTROL SETTINGS (OPTIONAL)





000001-400

no field001-400cm





000001-400

no field001-400cm

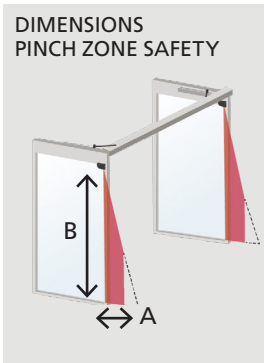
A teach-in overwrites these values automatically.



In order to change these settings by remote control, adjust DIP-switch 4 to ON



000001-100

no field001-100*040cm



000001-400

no field001-400cm

* The actual dimensions depend on the mounting height (100 cm at 4 m).
A teach-in overwrites these values automatically.

OUTPUT CONFIGURATION

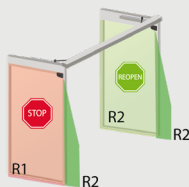

		1	2	3	4		
R1	NO	NC	NC	NO		NO	NC
R2	NC	NO	NC	NO		NO POWER	
						NO DETECTION	
						DETECTION	

NO = normally open
NC = normally closed

IMMUNITY FILTER

In order to change these settings by remote control, adjust DIP-switch 2 to ON

	1	2	3	4	5	6	7	8	9
	low	>	>	>	>	>	>	>	high

Increase to filter out external disturbances.
The reaction time increases significantly between value 5 and 9.

UNCOVERED ZONE



In order to change these settings by remote control, adjust DIP-switch 2 to ON

F2	1	2	3	4	5	6	7	8	9	
	2	4	6	8	10	12	14	16	18	cm*

Increase in case of snow, dead leaves, etc.
* measured in specific conditions and dependant on application and installation.

ANTIMASKING & BACKGROUND

In order to change these settings by remote control, adjust DIP-switch 3 to ON

	«□»	0	1	2	3	
ANTIMASKING		OFF	OFF	ON	ON	
BACKGROUND		OFF	ON	OFF	ON	

Antimasking: protective function which detects an unwanted object nearby the laser window masking the vision field.
Background: reference point in the detection field of the sensor.
If no background is present, switch to off.

GENERAL

		0	8	9
		teach-in	full reset	partial reset
		See page 8	Factory reset of all values	Factory reset of all values except field dimensions and output configurations

FACTORY VALUE

HOW TO USE THE REMOTE CONTROL



After unlocking, the red LED flashes and the sensor can be adjusted by remote control.



If the red LED flashes quickly after unlocking, you need to enter an access code from 1 to 4 digits. If you do not know the access code, **cut and restore the power supply**. During 1 minute, you can access the sensor without introducing any access code.



To end an adjustment session, always lock the sensor.

It is recommended to use a different access code for each module in order to avoid changing settings on both modules at the same time.

SAVING AN ACCESS CODE

The access code is recommended for sensors installed close to each other.



DELETING AN ACCESS CODE

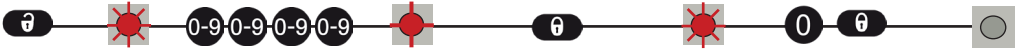

Enter the existing code

ADJUSTING ONE OR MORE PARAMETERS

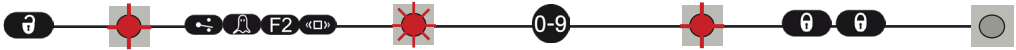

CHECKING A VALUE



x = number of flashes = value of the parameter

2x 1x 3x 1x 5x = field width: 2.35 m

RESTORING TO FACTORY VALUES

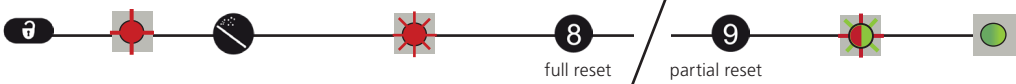

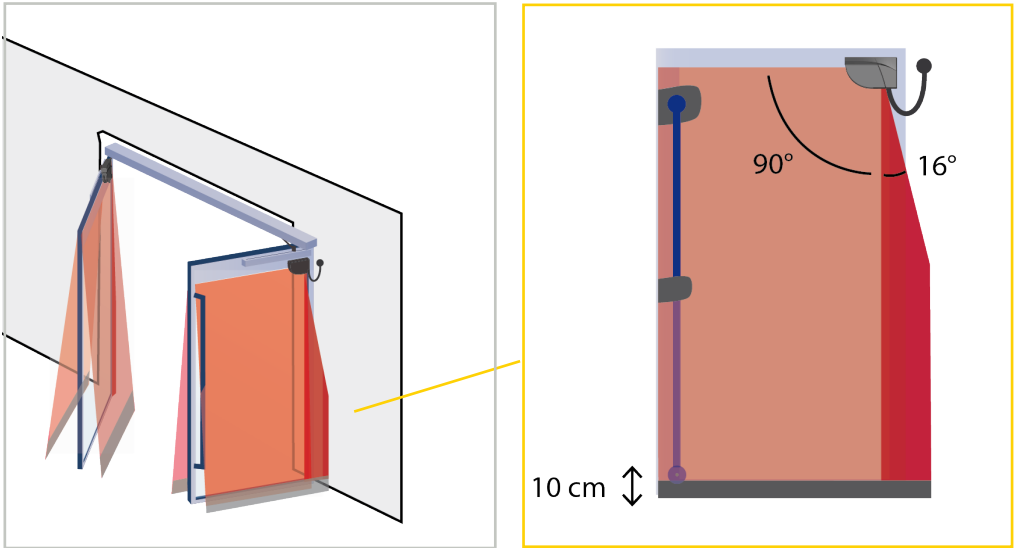

- DOOR WING SAFETY**
Typ. object size: 10 cm at 4 m
- PINCH ZONE SAFETY**
Typ. object size: 2 cm at 4 m
- UNCOVERED ZONE**
Adjustable by remote control
factory value: 10 cm

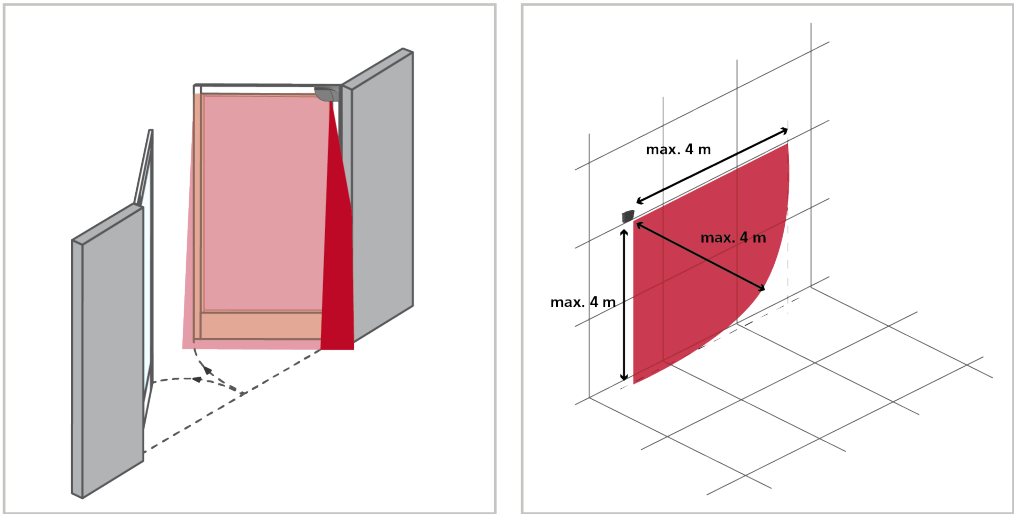

Check the detection fields using our online sizer tool:
bea-flatscan.com/sizer



TROUBLESHOOTING



In case of unwanted reactions of the door, verify whether the problem is caused by the sensor, the door controller or a radar sensor in proximity. To do so, activate the service mode (no safety) and launch a door cycle.
If the door cycle is completed successfully, check the sensor. If not, verify the door controller, the wiring or a radar sensor.

Keep a minimum distance of 15 cm between the FLATSCAN and radar sensors or use the *LZR®-FLATSCAN Protective cover* to avoid unwanted reactions of the door.











The RED or GREEN LED is ON sporadically or permanently and the door does not react as expected.	Bad teach-in		Launch a new teach-in (closed door).
	Unwanted detections (due to environment or external conditions)	1	Make sure the flexible cable does not cause detections.
		2	Verify if the laser window is dirty and clean it with compressed air. Then wipe it carefully with a damp and clean microfibre cloth if necessary (attention: the surface of the laser window is delicate)
		3	Launch a new teach-in (closed door).
		4	Switch DIP 2 to off (critical environment).



The sensor does not react at power-on.	Inverted power supply		Check wiring (green +, brown -).
	Faulty cable		Replace cable
	Faulty sensor		Replace sensor
The sensor does not react when powered.	Test error		Check voltage between red and blue wires.
			Press the push button during at least 3 seconds to exit the service mode.



It is not possible to adjust a setting by remote control.	Wrong DIP-switch position.		Adjust the required DIP-switches to ON.
The remote control does not react.	The sensor is protected by a password.		Enter the right password. If you forgot the code, cut and restore the power supply to access the sensor without entering a password during 1 minute.

	The ORANGE LED is on permanently.	The sensor encounters a memory problem.		Send the sensor back for a technical check-up.
	The ORANGE LED flashes quickly.	DIP-switch setting awaiting confirmation.		Confirm the DIP-switch setting: long push on the push button.
	The ORANGE LED flashes 1 x every 3 seconds.	The sensor signals an internal fault.		Cut and restore power supply. LED flashes again, replace sensor.
	The ORANGE LED flashes 2 x every 3 seconds.	Power supply is out of limit.	1	Check power supply (voltage, capacity).
			2	Reduce the cable length or change cable.
	The ORANGE LED flashes 3 x every 3 seconds.	Communication error between modules		Protect the sensor from any heat source (sun, hot air...)
			1	Check wiring between master and slave modules.
	The ORANGE LED flashes 4 x every 3 seconds.	Something close to the sensor is masking part of the detection field.	2	Check wiring between interface card and laser head.
			3	Press the push button during 3 seconds if the MASTER-SLAVE cable is permanently removed.
				Switch DIP 3 to off (deactivates background).
			1	Make sure the laser window is not scratched. If it is, replace sensor.
	The ORANGE LED flashes 5 x every 3 seconds.	Teach-in error	2	Remove all masking elements (insects, spider web, flexible tube, window protection).
			3	Verify if the laser window is dirty and clean it with compressed air. Then wipe it carefully with a damp and clean microfibre cloth if necessary (attention: the surface of the laser window is delicate)
			4	Switch antimasking setting to off (attention: no conformity to DIN 18650 or EN 16005).
			1	Check whether all teach-in requirements are fulfilled (see page 8) and launch a new teach-in (closed door).
	The ORANGE LED flashes 6 x every 3 seconds.	Permanent faulty measurements of door position.	2	Adjust the tilt angle of the laser curtain and launch a new tach-in (closed door).
			3	Adjust the field dimensions by remote control. Push  and activate a door opening (step 3 of teach-in).
			1	Launch a new teach-in (closed door).
			2	If orange LED flashes again, contact BEA.
	The ORANGE LED flashes 6 x every 3 seconds.	Sporadic faulty measurements of door position.	1	Clear field and wait until the door closes.
			2	If the door does not close, cut power supply and restore it once the door is fully closed.
			3	Launch a new teach-in (closed door).

©BEA | Original instructions | 42.8511 / V5 - 01.18 | A HALMA COMPANY | PLEASE KEEP FOR FURTHER USE - DESIGNED FOR COLOUR PRINTING

TECHNICAL SPECIFICATIONS

Technology	LASER scanner, time-of-flight measurement
Detection mode	Presence
Max. detection range	4 m (diagonal) with reflectivity of 2% (i.e. : at W = 1.5m -> max. H = 3.7 m)
Opening angle	Door wing safety: 90° / Pinch zone safety: 16°
Angular resolution	Door wing safety: 1.3°/ Pinch zone safety: 0.2°
Typ. min. object size	Door wing safety 10 cm @ 4m (in proportion to object distance, DIP 2 = ON) Pinch zone safety 2 cm @ 4m (in proportion to object distance, DIP 2 = ON)
Testbody	700 mm × 300 mm × 200 mm (testbody CA according to EN 16005 & DIN 18650)
Emission characteristics	IR LASER: wavelength 905 nm; max. output pulse power 25 W; Class 1
Supply voltage	12 - 24 V DC ± 15 %
Power consumption	≤ 2 W
Response time	Door wing safety: max. 50 ms / Pinch zone safety: max. 90 ms
Output	2 electronic relays (galvanic isolation - polarity free)
Max. switching voltage	42V AC/DC
Max. switching current	100 mA
LED-signals	1 bi-coloured LED: detection/output status
Dimensions	142 mm (L) × 85 mm (H) × 33 mm (D) (mounting base + 7 mm)
Material - Colour	PC/ASA - Black - Aluminum - White
Tilt angles	+2° to +10° (without mounting base)
Protection degree	IP54 (EN 60529)
Temperature range	-30°C to +60°C if powered
Humidity	0-95 % non-condensing
Vibrations	< 2 G
Min. door wing speed	2°/sec
Norm conformity	EN 12978; EN ISO 13849-1 PI "d"/ CAT2; IEC 60825-1; EN 60950-1; EN 61000-6-2; EN 61000-6-3; EN 62061 SIL 2; DIN 18650-1 Chapter 5.7.4 (testbody CA); EN 16005 Chapter 4.6.8 (testbody CA) AS 5007:2007

Specifications are subject to change without prior notice.
All values measured in specific conditions.



BEA SA | LIEGE Science Park | ALLÉE DES NOISETIERS 5 - 4031 ANGLEUR [BELGIUM] | T +32 4 361 65 65 | F +32 4 361 28 58 | INFO@BEA.BE | WWW.BEA-SENSORS.COM



BEA hereby declares that the LZR®-FLATSCAN SW is in conformity with the basic requirements and the other relevant provisions of the directives 2014/30/EU, 2014/35/EU, 2006/42/EC and 2011/65/EU.
Notified Body for EC-type inspection: 0044 - TÜV NORD CERT GmbH, Langemarckstr. 20, D-45141 Essen
EC-type examination certificate number: 44 205 13 089619
Angleur, August 2017 Pierre Gardier, authorized representative and responsible for technical documentation
The complete declaration of conformity is available on our website.



Only for EC countries: According to the European Guideline 2012/19/EU for Waste Electrical and Electronic Equipment (WEEE)